

Courses and Distances
from Hoop Ash up Juniata —

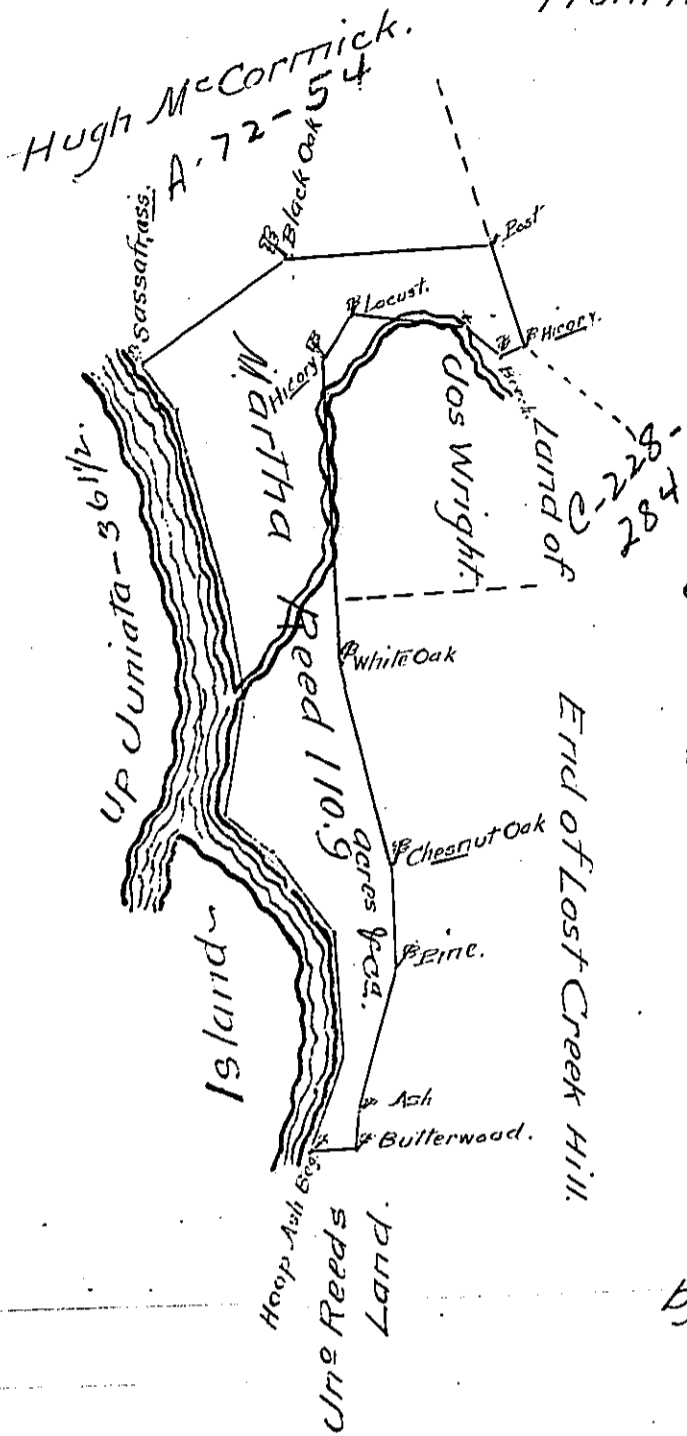

- N. 5 E. 44.
 - N. 19 W. 50.
 - N. 52 W. 44.
 - N. 68 W. 25.
 - N. 5 W. 49 1/2.
 - N. 25 W. 40.
 - N. 30 W. 84.
 - N. 48 W. 25. to Sassafras.
- 36 1/2

- and by Hugh McCormick
- N. 40 E. 74 Black Oak
 - N. 71 E. 90 Post and by
 - Wm McCartney's Land
 - S. 32 E 44 Hicory
- By Joseph Wright:
- S. 45 W. 10 Beech down
 - Lost Creek
 - N. 63 W. 18
 - S. 80 W. 56 Locust
 - S. 19 W. 20 Hicory
 - S. 18 E. 129 White Oak
- by End of Lost Creek Hill
- S. 30 E. 85 Chesnut Oak.
 - S. 18 E. 43 Pine
 - South 65 Ash
 - S. 8 E. 16 Butterwood
 - S. 71 W. 18 to the Begin^g.

The Draught of a Tract of Land called Partial Survey situate on the mouth of Lost Creek on the north side of Juniata—in the County of Cumberland containing One Hundred Ten acres 15³ Perches with the usual allowance of Six acres $\frac{1}{2}$ Cent. for Roads. Survey'd the 1st day of August Anno Dom: 1768—In Pursuance of an Order of Survey to Martha Reed Bearing Date at Philad. the 7th day of September Anno Dom: 1767 and numbered 4357

Wm Maclay D.S.

To John Lukens Esq. }
S.G. of Pennsylvania— }

IN TESTIMONY that the above is a copy of the original remaining on file in the Department of Internal Affairs of Pennsylvania, made conformably to an Act of Assembly approved the 16th day of February, 1833, I have hereunto set my Hand and caused the Seal of said Department to be affixed at Harrisburg, this tenth day of April 1906.

Geo. P. Brown
Secretary of Internal Affairs.